

## Copper Washer

For BSPP (G) Male stud ends

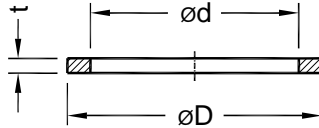

Part No.	For male thread BSP	Ød	ØD	t
<b>CWG01</b>	G 1/8	10.20	13.90	1.00
<b>CWG02</b>	G 1/4	14.20	17.90	1.50
<b>CWG03</b>	G 3/8	17.20	20.90	1.50
<b>CWG04</b>	G 1/2	21.20	25.90	1.50
<b>CWG06</b>	G 3/4	27.30	31.90	2.00
<b>CWG08</b>	G 1	33.30	38.90	2.00
<b>CWG10</b>	G1 1/4	42.30	48.90	2.00
<b>CWG12</b>	G1 1/2	48.30	54.90	2.00
<b>CWG16</b>	G2	60.50	67.80	2.50